

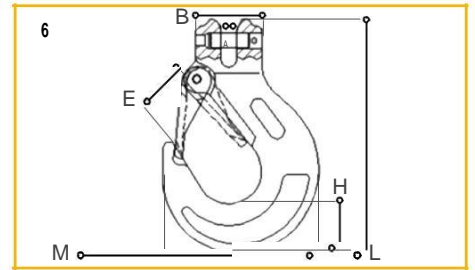
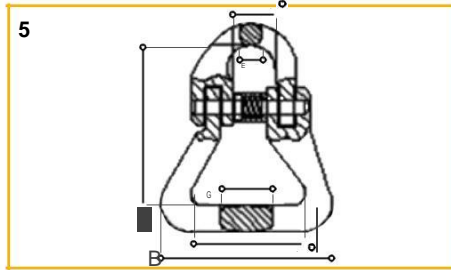
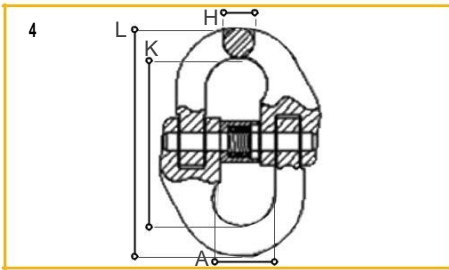

Grade 80 Toebehoren / Grade 80 Accessories

4. Verbindingschalmen /
Connecting links5. Verbindingschalmen voor
rondstroppen en kettingen /
Connecting links for chains and
round slings6. Gaffelhaken met klep /
Clevis hooks with latch

4 Verbindingschalmen / Connecting links Afmetingen / Dimensions							
Item no.	WLL (ton)	A	L	K	H	Weight (kg)	
YE.8.015.06	1.12	15.00	58.00	42.00	7.00	0.08	
YE.8.015.07	1.50	19.00	71.80	54.80	8.50	0.15	
YE.8.015.08	2.00	18.00	79.50	60.50	8.50	0.16	
YE.8.015.10	3.15	25.00	93.00	68.00	10.80	0.30	
YE.8.015.13	5.30	29.00	117.00	87.00	15.00	0.70	
YE.8.015.16	8.00	34.50	148.00	108.40	19.80	1.10	
YE.8.015.20	12.50	38.00	169.50	121.50	24.00	1.80	
YE.8.015.22	15.00	48.00	193.50	141.50	26.00	3.20	
YE.8.015.26	21.20	84.80	220.00	158.00	30.00	4.50	
YE.8.015.32	31.50	67.00	281.00	205.00	37.00	9.00	

5 Verbindingschalmen voor rondstroppen en kettingen / Connecting links for chains & webbing slings Afmetingen / Dimensions								
Item no.	WLL (ton)	A	B	K	W	g	E	Weight (kg)
YE.8.016.06	1.12	15.00	60.00	56.00	40.00	18.00	7.00	0.20
YE.8.016.08	2.00	20.00	61.50	63.70	40.00	24.00	9.50	0.30
YE.8.016.10	3.15	24.00	66.00	83.00	39.00	30.50	11.00	0.68
YE.8.016.13	5.30	28.00	88.00	93.70	55.00	36.80	16.50	1.47
YE.8.016.16	8.00	34.50	108.00	120.00	65.50	45.20	19.80	2.30
YE.8.016.20	12.50	41.00	129.00	138.00	80.00	51.80	23.00	3.30
YE.8.016.26	21.20	58.00	228.40	209.50	152.00	86.00	30.00	10.62
YE.8.016.32	31.50	72.50	252.00	279.00	160.00	91.00	37.00	18.92

6 Gaffelhaken met klep / Clevis hooks with cast latch Afmetingen / Dimensions								
Item no.	WLL (ton)	A	B	E	H	M	L	Weight (kg)
YE.8.043.06	1.12	7.50	32.00	19.50	20.00	68.00	108.00	0.33
YE.8.043.08	2.00	9.50	38.50	24.00	27.50	87.50	131.00	0.55
YE.8.043.10	3.15	13.00	48.00	28.00	36.00	106.00	163.50	0.96
YE.8.043.13	5.30	16.50	57.00	34.50	41.60	130.00	196.00	1.52
YE.8.043.16	8.00	18.50	65.50	43.00	48.20	155.50	238.00	3.43
YE.8.043.20	12.50	24.00	92.00	51.50	51.00	180.00	281.00	6.73
YE.8.043.22	15.00	27.00	90.50	69.50	63.00	220.00	315.00	10.00
YE.8.043.26	21.20	30.00	117.00	85.00	75.00	252.00	325.00	14.50
YE.8.043.32	31.50	35.00	150.00	106.00	88.00	300.00	405.00	27.00

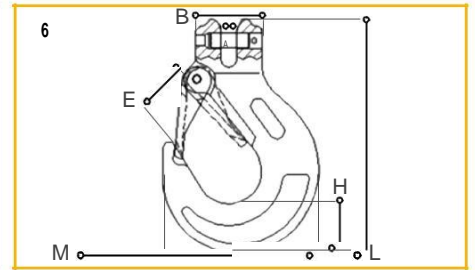
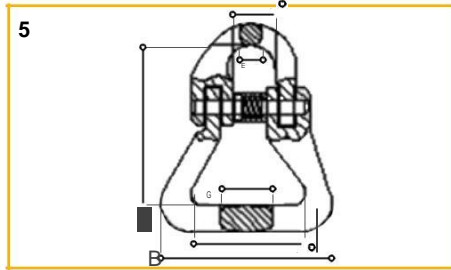
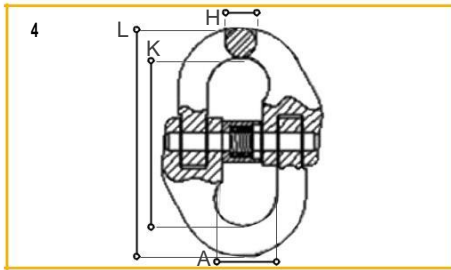

Grade 80 Accessoires / Grade 80 Zubehör

4. Maillons connecteurs /
Verbindungsglieder5. Maillons connecteurs pour
élingues rondes et chaînes /
Verbindungsglieder für Ketten und
Rundschlingen6. Crochets à chape avec
linguet de sécurité /
Gabelkopfhaken mit
Schnapp-Verriegelung

4							
Maillons connecteurs / Verbindungsglieder							
Dimensions / Abmessungen (mm)							
Item no.	WLL (ton)	A	L	K	H	Weight (kg)	
YE.8.015.06	1.12	15.00	58.00	42.00	7.00	0.08	
YE.8.015.07	1.50	19.00	71.80	54.80	8.50	0.15	
YE.8.015.08	2.00	18.00	79.50	60.50	8.50	0.16	
YE.8.015.10	3.15	25.00	93.00	68.00	10.80	0.30	
YE.8.015.13	5.30	29.00	117.00	87.00	15.00	0.70	
YE.8.015.16	8.00	34.50	148.00	108.40	19.80	1.10	
YE.8.015.20	12.50	38.00	169.50	121.50	24.00	1.80	
YE.8.015.22	15.00	48.00	193.50	141.50	26.00	3.20	
YE.8.015.26	21.20	84.80	220.00	158.00	30.00	4.50	
YE.8.015.32	31.50	67.00	281.00	205.00	37.00	9.00	

5								
Maillons connecteurs pour élingues rondes et chaînes / Verbindungsglieder für Ketten und Rundschlingen								
Dimensions / Abmessungen (mm)								
Item no.	WLL (ton)	A	B	K	W	g	E	Weight (kg)
YE.8.016.06	1.12	15.00	60.00	56.00	40.00	18.00	7.00	0.20
YE.8.016.08	2.00	20.00	61.50	63.70	40.00	24.00	9.50	0.30
YE.8.016.10	3.15	24.00	66.00	83.00	39.00	30.50	11.00	0.68
YE.8.016.13	5.30	28.00	88.00	93.70	55.00	36.80	16.50	1.47
YE.8.016.16	8.00	34.50	108.00	120.00	65.50	45.20	19.80	2.30
YE.8.016.20	12.50	41.00	129.00	138.00	80.00	51.80	23.00	3.30
YE.8.016.26	21.20	58.00	228.40	209.50	152.00	86.00	30.00	10.62
YE.8.016.32	31.50	72.50	252.00	279.00	160.00	91.00	37.00	18.92

6								
Crochets à chape avec linguet de sécurité / Gabelkopfhaken mit Schnapp-Verriegelung								
Dimensions / Abmessungen (mm)								
Item no.	WLL (ton)	A	B	E	H	M	L	Weight (kg)
YE.8.043.06	1.12	7.50	32.00	19.50	20.00	68.00	108.00	0.33
YE.8.043.08	2.00	9.50	38.50	24.00	27.50	87.50	131.00	0.55
YE.8.043.10	3.15	13.00	48.00	28.00	36.00	106.00	163.50	0.96
YE.8.043.13	5.30	16.50	57.00	34.50	41.60	130.00	196.00	1.52
YE.8.043.16	8.00	18.50	65.50	43.00	48.20	155.50	238.00	3.43
YE.8.043.20	12.50	24.00	92.00	51.50	51.00	180.00	281.00	6.73
YE.8.043.22	15.00	27.00	90.50	69.50	63.00	220.00	315.00	10.00
YE.8.043.26	21.20	30.00	117.00	85.00	75.00	252.00	325.00	14.50
YE.8.043.32	31.50	35.00	150.00	106.00	88.00	300.00	405.00	27.00