



Grade 100 Toebehoren / Grade 100 Accessories

1. Topschaklen / Master links



2. Topschaklen met verloopingen / Master links assemblies



3. Verbindingschaklen / Connecting links

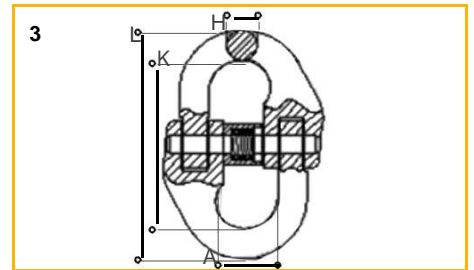
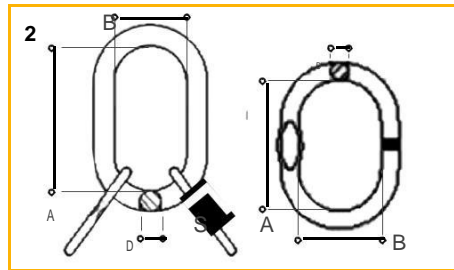
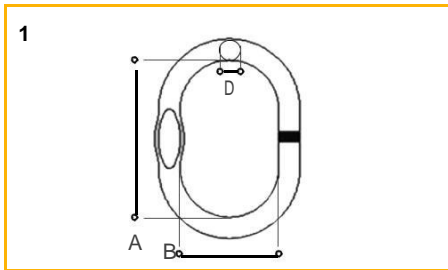

1		Topschaklen / Masterlinks Afmetingen / Dimensions						
Item no.	WLL (ton)	A	B	D			Weight (kg)	
YE.10.079.08.06	2.50	120.00	70.00	14.00			0.40	
YE.10.079.10.08	4.00	140.00	80.00	17.00			0.70	
YE.10.079.13.10	7.50	160.00	95.00	22.00			1.50	
YE.10.079.16.13	10.00	190.00	110.00	25.00			2.20	
YE.10.079.20.18	17.00	240.00	140.00	34.00			5.10	
YE.10.079.22.20	25.00	250.00	150.00	38.00			7.20	

2		Topschaklen met verloopingen / Master links assemblies Afmetingen / Dimensions						
Item no.	WLL (ton)	A	B	D	a	b	d	Weight (kg)
YE.10.080.06	3.00	135.00	75.00	19.00	54.00	25.00	13.00	1.30
YE.10.080.08	5.30	160.00	90.00	23.00	70.00	34.00	16.50	2.33
YE.10.080.10	8.00	180.00	100.00	27.00	85.00	40.00	19.00	3.70
YE.10.080.13	14.00	200.00	110.00	33.00	115.00	50.00	23.00	6.50
YE.10.080.16	21.20	260.00	140.00	36.00	140.00	65.00	27.00	10.10
YE.10.080.20	33.60	350.00	190.00	50.00	180.00	90.00	33.00	24.15
YE.10.080.22	39.90	350.00	190.00	50.00	180.00	100.00	36.00	26.00

3		Verbindingschaklen / Connecting links Afmetingen / Dimensions						
Item no.	WLL (ton)	H	A	K	L		Weight (kg)	
YE.10.015.06	1.4	7.6	14.0	44.5	60.0		0.10	
YE.10.015.08	2.5	10.0	18.5	61.5	84.5		0.22	
YE.10.015.10	4.0	12.6	23.0	72.0	97.2		0.45	
YE.10.015.13	6.7	16.8	27.5	89.0	127.0		1.15	
YE.10.015.16	10.0	21.0	33.5	103.0	145.0		1.75	
YE.10.015.20	16.0	24.5	42.0	116.0	175.0		2.70	
YE.10.015.22	19.0	27.0	48.0	135.0	193.0		4.02	
YE.10.015.26	26.5	32.0	61.0	164.0	228.0		5.10	
YE.10.015.32	39.3	40.0	80.0	194.0	274.0		8.50	

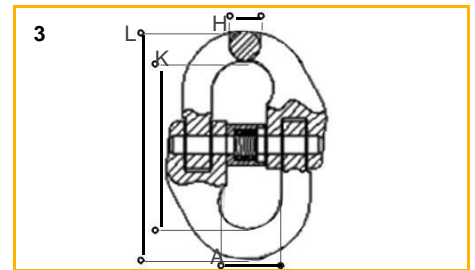
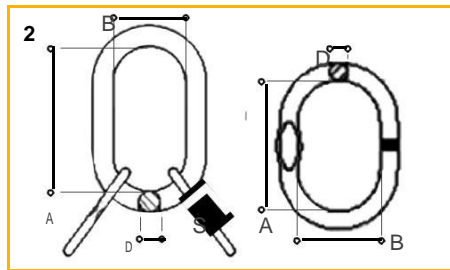
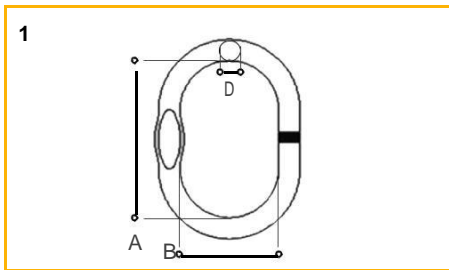

Grade 100 Accessoires / Grade 100 Zubehör

1. Maillons principaux
/ Aufhängeringe2. Maillons principaux avec bagues
d'adaptation / Aufhängeringe mit
Verbindungsringen3. Maillons connecteurs /
Verbindungsglieder

1							Maillons principaux / Aufhängeringe	
Item no.							Dimensions / Abmessungen (mm)	
	WLL (ton)	A	B		D		Weight (kg)	
YE.10.079.08.06	2.50	120.00	70.00		14.00		0.40	
YE.10.079.10.08	4.00	140.00	80.00		17.00		0.70	
YE.10.079.13.10	7.50	160.00	95.00		22.00		1.50	
YE.10.079.16.13	10.00	190.00	110.00		25.00		2.20	
YE.10.079.20.18	17.00	240.00	140.00		34.00		5.10	
YE.10.079.22.20	25.00	250.00	150.00		38.00		7.20	

2									Maillons principaux avec bagues d'adaptation / Aufhängeringe mit Verbindungsringen	
Item no.									Dimensions / Abmessungen (mm)	
	WLL (ton)	A	B	D	a	b	d		Weight (kg)	
YE.10.080.06	3.00	135.00	75.00	19.00	54.00	25.00	13.00		1.30	
YE.10.080.08	5.30	160.00	90.00	23.00	70.00	34.00	16.50		2.33	
YE.10.080.10	8.00	180.00	100.00	27.00	85.00	40.00	19.00		3.70	
YE.10.080.13	14.00	200.00	110.00	33.00	115.00	50.00	23.00		6.50	
YE.10.080.16	21.20	260.00	140.00	36.00	140.00	65.00	27.00		10.10	
YE.10.080.20	33.60	350.00	190.00	50.00	180.00	90.00	33.00		24.15	
YE.10.080.22	39.90	350.00	190.00	50.00	180.00	100.00	36.00		26.00	

3							Maillons connecteurs / Verbindungsglieder	
Item no.							Dimensions / Abmessungen (mm)	
	WLL (ton)	H	A	K	L		Weight (kg)	
YE.10.015.06	1.4	7.6	14.0	44.5	60.0		0.10	
YE.10.015.08	2.5	10.0	18.5	61.5	84.5		0.22	
YE.10.015.10	4.0	12.6	23.0	72.0	97.2		0.45	
YE.10.015.13	6.7	16.8	27.5	89.0	127.0		1.15	
YE.10.015.16	10.0	21.0	33.5	103.0	145.0		1.75	
YE.10.015.20	16.0	24.5	42.0	116.0	175.0		2.70	
YE.10.015.22	19.0	27.0	48.0	135.0	193.0		4.02	
YE.10.015.26	26.5	32.0	61.0	164.0	228.0		5.10	
YE.10.015.32	39.3	40.0	80.0	194.0	274.0		8.50	